

Nathan EVANS

Vacant
A-83-241
Land

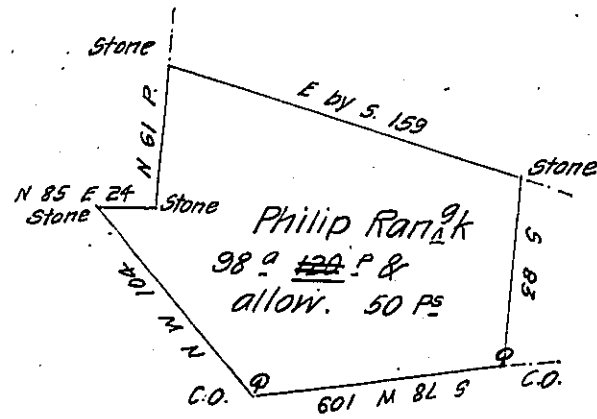

C-50-121

Nathan EVANS
in Right of
William EVANS

Vacant Land

By Virtue of a Warrant dated the 26th day of the 9th month
 1751 Surveyed on the 7th day of the 3rd month 1753 unto Philip Ran^{gk}
 the above described Tract of Land Situate in Erle Township in the County
 of Lancaster &c.

Benja Lightfoot -

IN TESTIMONY that the above is a copy of the original remaining on file in
 the Department of Internal Affairs of Pennsylvania, made
 conformably to an Act of Assembly approved the 16th day of
 February, 1833, I have hereunto set my Hand and caused
 the Seal of said Department to be affixed at Harrisburg,
 this eighth day of August 1906

Loae D. Brown
 Secretary of Internal Affairs.